

# 0036

**36th** | **CALIBRE**  
Annual | Design Awards

**NOMINEES**

Winners will be announced at the Gala Event  
Beverly Wilshire Hotel  
May 3, 2024

**[Click here](#)** for tickets and event details



### **Del Oro High School**

Nominated by: HMC Architects  
Hohbach-Lewin  
TK1SC  
RIOS  
Ruzika Company, INC.  
S.C. Anderson, Inc.



### **University of California | Irvine College of Health Sciences and School of Nursing**

Nominated by: HED  
The S/L/A/M Collaborative  
Pickett Design Associates  
Hathaway Dinwiddie Construction Company  
Saiful Bouquet  
Alvine Engineering



### **Wonderful Career Center**

Nominated by: AECOM  
Migcom  
Klassen & Smith  
PLP SoCal  
The Wonderful Company



### **Cedars-Sinai Mink Radiologic Imaging- Marina**

Nominated by: Abramson Architects  
Cedars-Sinai Health System  
TIS Construction Services  
REX Engineering  
Vince Tarango  
Pivot Interiors



### **Clover Dental**

Nominated by: Studio Murnane  
JS & Associates  
Burkhart Dental Supply  
Clover Orthodontic Studio



### **Kaiser Permanente Watts Medical Offices and Counseling and Learning Center**

Nominated by: Perkins & Will  
Kaiser Permanente  
Kevin Barry Art Advisory  
Systems Source  
HLB Lighting  
Swinerton



### **Mini Pearl IVF Clinic**

Nominated by: Ware Malcomb  
Align Builders  
Bandak Project Management  
H+W



### **UCLA Encino Medical Facility**

Nominated by: KARDENT  
SWA Architects  
CONAM Building Co  
ARTWORKS  
Tangram Interiors



### **UCLA Health Barbara Kort Women's Imaging Center**

Nominated by: KARDENT  
SWA Architects  
CONAM Building Co  
Tangram Interiors  
Tahiti Cabinets  
ARTWORKS





### **ATLA Venice**

Nominated by: Loescher Meachem Architects  
Taller ADG  
Holmes  
Clay Enterprises



### **Avatar Coffee Roasters**

Nominated by: Hendy  
Details Custom Builders, Inc.  
Catalyst Retail  
Plantscapers



### **Caló Kitchen + Tequila**

Nominated by: VANROOY design  
Calo Kitchen and Tequila  
T.S. Voelker Architecture  
Coastal Pacific Construction, Inc.  
Moen Millworks, Inc.  
Modern Building Team



### **Shore House at The Del, Curio Collection by Hilton**

Nominated by: LEO A DALY  
Blackstone  
The Carroll Adams Group  
Swinerton



### **The Hadsten Solvang, Tapestry Collection by Hilton**

Nominated by: HBG Design  
Chavez-Grieves  
I.C. Thomasson  
Rick Engineering  
Fred Schmid & Associates  
Halsell Builders



### **Tribù Flagship Showroom**

Nominated by: NCA Studio, Inc.  
Oceanparkstudio  
Marc Merckx Interiors  
Gomringer Kuhl Builders  
Beverly Gemini Investments  
MEP California Engineering Corp



### **Bloom South Coast**

Nominated by: Mannigan Design, Inc.  
Legacy Partners  
TCA Architects  
Johnstone Moyer, Inc.  
PCW Millworks



### **Chroma**

Nominated by: Vida Design  
Fairfield  
Parade  
Tube Art  
Astek



### **Halcyon House**

Nominated by: Hendy  
Quarterra  
KTGY  
MJS Landscape Architecture  
Corporate Business Interiors



### **Santal Thousand Oaks**

Nominated by: CDC Designs  
RCI General Contractors  
KTGY  
BMLA Landscape Architects  
The Latigo Group



### **The Society - Ruby**

Nominated by: Vida Design  
Holland Partner Group  
ABG Art Group  
HBB  
Sanwood Fine Carpentry & Construction, Inc.



### **Union Grantville**

Nominated by: Gensler  
GroundLevel Landscape Architecture, Inc.  
Greystar  
Van Tilburg, Banvard, & Soderbergh  
Carol Braslow



### **CenterPark Amenities Building**

Nominated by: HGA  
Ferguson Pape Baldwin Architects  
Coffman Engineers  
H+W Engineering  
Spurlock Landscape Architects  
bkm Officeworks



### **Confidential Client Lobby and Event Space**

Nominated by: Klawiter and Associates  
Hathaway Dinwiddie Construction Co  
Longman Lindsey Acoustical Consultants  
Teklogic  
Taber Co  
Wall Panel Systems Co





### **Cedars Sinai Board of Governors Innovation Center**

Nominated by: HDR Architecture  
Rudolph and Sletten  
Sheridan Group  
Skyline Design



### **Confidential Tech Client, Immersive Hospitality & Events Spaces**

Nominated by: ZGF  
Swinerton  
SPMD  
One Hat One Hand  
Unisource Solutions  
FMS



### **Los Angeles Design Center**

Nominated by: Parco Studio  
GCX  
Hughes Marino  
KTA Engineering  
Pivot Interiors



### **Marlin Equity**

Nominated by: Gensler  
Marlin Equity Partners  
Coyle Construction  
KGM Architectural Lighting  
DCI Engineers  
Place Landscape



### **Navy SEAL Foundation**

Nominated by: Gensler  
Navy SEAL Foundation  
Virginia High Performance  
DPR Construction  
MA Engineers Inc.



### **NeueHouse Venice Beach**

Nominated by: Loescher Meachem Architects  
DesignAgency  
J.T. Magen Construction Group  
NeueHouse



### **Terasaki Institute Erwin Building, Terasaki Institute for Biomedical Innovation**

Nominated by: CO Architects  
Terasaki Institute for Biomedical Innovation  
P2S, Inc.  
MATT Construction  
KPF Consulting Engineers



### **Tricon Residential**

Nominated by: ShubinDonaldson  
Sierra Pacific Constructors  
DEB Construction, LLC  
Studio Other  
TK1SC  
JLL





### **Albert Einstein Academy Charter High School**

Nominated by: DLR Group  
San Diego Unified School District  
Visual Asylum  
Groundlevel  
MA Engineers  
Johnson Consulting Engineers



### **Allensworth Passage**

Nominated by: SmithGroup



### **Century City Cultural Pavilion**

Nominated by: Gensler  
KPF Consulting Engineers  
Newson Brown Acoustics LLC  
PlanNet  
Oculus Light Studio  
Mark Tessier Landscape Architecture

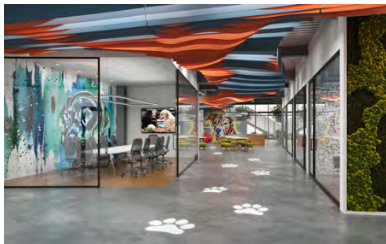

### **Company Confidential**

Nominated by: O Arch, Inc.  
Lincoln Property Company  
Engineered Spaces, Inc.  
Office Furniture Group



### **Long Beach City College - Campus Center**

Nominated by: HPI Architecture  
Long Beach City College  
MHP Structural Engineers  
P2S Inc.  
Ridge Landscape Architects



### **Magnolia Public Charter School**

Nominated by: DLR Group  
Magnolia Public School  
Lynn Capouya, Inc.  
Erickson Hall  
VCA Engineers



### **Mt. San Antonio College - Technology and Health Replacement Building**

Nominated by: HPI Architecture  
Mt. San Antonio Community College District  
Sim Health Group  
MHP Structural Engineers  
HERA Laboratory Planners



### **Orange County Sanitation District New Headquarters Building**

Nominated by: HDR Architecture  
Swinerton  
Waveguide  
PeopleSpace



### **Petco Park Agave Club and Lounge**

Nominated by: Gensler  
San Diego Padres  
Henderson Engineering  
Thornton Tomasetti  
Ashley Donahue Design



### **Redlands Residences**

Nominated by: DLR Group  
UCR Group LLC  
Christiansen & Company  
LandArq, Inc.  
GOUVIS Engineering  
Williams Sonoma, Inc.



### **Rosemead Transition School**

Nominated by: DLR Group  
El Monte Union High School District  
DCGA Engineers  
Silverbar Studio  
SWS Engineers, Inc.  
Pacific Fire Engineering

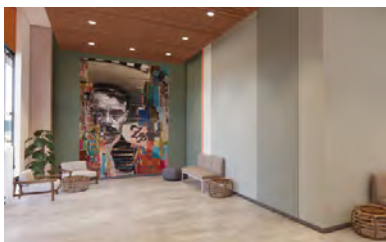

### **UC San Diego, Ridge Walk North Living and Learning Neighborhood**

Nominated by: HMC Architects  
Hensel Phelps  
EYRC  
SWA  
DCI  
MA Engineers



### **DSV Global Transport and Logistics**

Nominated by: Ware Malcomb  
Turek, Inc.  
HSA & Associates, Inc.  
AlfaTech



### **Dine Brands**

Nominated by: Gensler  
Dine Brands  
Sierra Pacific Constructors  
Systems Source  
SAW & Associates  
ARC Engineering



### **Supernal, Laguna Canyon**

Nominated by: RMW  
HITT Contracting  
One Workplace  
Habitat Horticulture  
O+A



### **Tandem Diabetes Headquarters**

Nominated by: ID Studios, Inc.  
Burger Construction  
CBRE  
GIM Business Interiors  
Shaw Contract  
MillerKnoll





### 9000 Wilshire

Nominated by: HLW  
Neil Denari Architects  
Skanska USA Commercial Development / Skanska USA Building  
Argento/Graham  
Saiful Bouquet  
Glumac Structural



### Affordable Housing Developer

Nominated by: MUL-MAC  
Ram Construction T  
Tangram Interiors  
DPPM Project Management



### Armata Pharmaceuticals

Nominated by: Worksmart Design  
AES Clean  
Friant  
L&K



### Biolabs Tenant Improvement

Nominated by: McFarlane Architects  
Biolabs  
JB Pacific  
Milliken  
Cultura



### Boldyn Networks

Nominated by: O Arch, Inc.  
Boldyn Networks  
The Irvine Company  
WSP  
Pacific Tusk Builders  
Office Furniture Group



### Confidential Arts District Firm

Nominated by: HOK  
HITT Contracting  
Henderson Engineers  
Tangram Interiors  
Tre Borden & Co.  
SCI Lighting





### **Confidential Client - MSG**

Nominated by: HLW  
JTM Construction Group, Inc  
G+T  
AMA Group  
Spark Studio Lighting Design LLC  
Office Furniture Group



### **Confidential Financial Client Los Angeles Office Renovation**

Nominated by: Corgan  
Confidential Financial Client  
Clune Construction  
Turner and Townsend  
Turf Design  
Jean Summer and Associates



### **Hartbeat LA**

Nominated by: Studio 7 Design Group  
HITT Contracting  
Hartbeat  
BAM Creative  
Tangram Interiors  
AMA Group



### **Illumina Executive Briefing Center**

Nominated by: ZGF  
BNB Builders  
Illumina  
Hyperquake



### **Nossaman LLP, Downtown Los Angeles**

Nominated by: SmithGroup  
HYL Architects  
AMA Group  
NOSSAMAN LLP  
Howard Building Corporation  
Bluespace Interiors



### **Omaze**

Nominated by: Revel Architecture & Design  
ECC  
ARC Engineering  
Insight Structural Engineers  
Steelcase  
Cushman Wakefield



### **Tri Pointe Homes**

Nominated by: Gensler  
Tri Pointe Homes Inc.  
Howard Building Corporation  
Systems Source  
KGM Architectural Lighting



### **United Talent Agency Bungalows**

Nominated by: RIOS  
ARC Engineering  
The Lighting Practice  
SAW & Associates  
JDM  
MASHstudios



### **Universal Music Publishing Group**

Nominated by: Gensler  
Oculus Light Studio  
Mark Tessier — Landscape Architecture Inc  
Newson Brown Acoustics, LLC  
Sheridan Group  
Corporate Contractors, Inc.



### **Whittier Trust**

Nominated by: Wolcott Architecture  
Lincoln Property Company  
Ram Construction  
GMBI



### **AEW**

Nominated by: Wolcott Architecture  
Pinnacle Construction  
The Sheridan Group  
Tangram + Studio Other

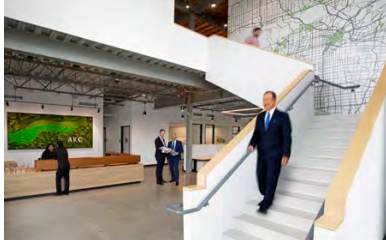

### **ARC Engineering**

Nominated by: MOZU Architects  
ARC Engineering  
ECC  
Structural Focus  
Pinnacle, Inc.



### **Alexandria Project**

Nominated by: Wolcott Architecture  
GCX  
Taber Co  
Pinnacle Communications Services  
SoCal Stone  
DFS Flooring



### **Design Firm in Tustin**

Nominated by: Taylor Design  
MUL-MAC  
Servco Construction  
Corporate Business Interiors  
Allsteel



### **Edwards Lifesciences Building D State-of-the-Art Auditorium**

Nominated by: Gensler  
Edwards Lifesciences  
PRJX  
Clune Construction  
Sound Image  
PlanNet



### **Financial Offices**

Nominated by: RIOS  
Del Amo Construction  
EEi  
ARC Engineering  
Syska Hennessy Group  
Uhuru Design





### **Hines West Edge LA**

Nominated by: Rapt Studio  
Seeley Brothers  
HITT Contracting  
Hines  
Studio Other  
Sheridan Group



### **Hologic Innovation Center**

Nominated by: AVRP Studios  
Geologic  
Pacific Building Group  
H+W Engineering  
Prime Structural Engineers  
Ickler Electric

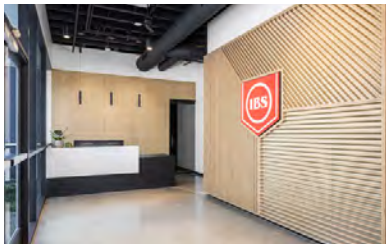

### **IBS Electronics**

Nominated by: ONE NINE Architecture  
ONE Maple  
PCW Millworks  
Cal Coast Flooring



### **Interior Design Studio**

Nominated by: IA Interior Architects  
Swinerton  
Bask  
TK1SC  
Plannet



### **Jacques Marie Mage**

Nominated by: Studio Murnane  
Makim Architecture  
JSA  
Warner Constructors



### **McKinsey & Company**

Nominated by: HLW  
GCX  
VVA LLC  
JLL  
AMA Group  
CD+M Lighting Design Group, LLC





### **Office of the Future**

Nominated by: Gensler  
Tectonics  
ARC Engineering  
Tangram + Studio Other  
Western Office



### **Pacific Companies**

Nominated by: HENDY  
Pacific Tusk Builders  
Tangram Interiors  
Terra Mai  
Graffiti  
HVAC Mechanical



### **Poms & Associates**

Nominated by: Studio Blitz  
GCX  
Tangram Interiors  
Living Art Aquarium  
Studio Other  
AMA Group



### **REVERIE**

Nominated by: DGA  
bkm Officeworks  
Bycor  
Shaw Contract  
SDLA



### **Shamrock Capital**

Nominated by: ShubinDonaldson  
Sierra Pacific Constructors  
ARC Engineering  
Studio Other  
AM Cabinets Inc.



### **The Resmark Companies**

Nominated by: Gensler  
Oculus Light Studio  
Howard Building Corporation  
AMA Group  
Western Office



### **Wienerschnitzel HQ**

Nominated by: O Arch, Inc.  
Galardi Group Inc.  
Lincoln Property Company  
Engineered Spaces, Inc.  
Details Custom Builders, Inc.  
Source Creative Office Interiors



### **Zuru**

Nominated by: Worksmart Design  
Shaw Contract  
Interface, Inc.  
Walters  
Interface